



FAIRWAY COURT, BOW, E3

£2,000 PCM

One Bedroom Apartment | First Floor | Modern Development |
Furnished | Open Plan Reception Room | Fitted Kitchen |
Private Balcony With River Views | Located Close To Bromley-
By-Bow Station

- First floor
- Furnished
- One bathroom
- One bedroom
- Private balcony

Situated on the first floor of a modern development, this furnished one-bedroom apartment offers comfortable living in a sought-after location.

The property features an open-plan reception room with a fully fitted kitchen, creating a spacious and contemporary feel throughout.

Step out onto your own private balcony and enjoy tranquil river views — perfect for morning coffee or unwinding after a busy day.

The master bedroom offers ample storage and features floor to ceiling windows and there is a modern family bathroom.

Ideally located just a short walk from Bromley-by-Bow station, this apartment offers excellent transport links into Central London, making it ideal for professionals or couples seeking convenience without compromising on comfort.

Deposit: £2,307.69

Holding Deposit: £461.53



FAIRWAY COURT, BOW, E3
£2,000 PCM

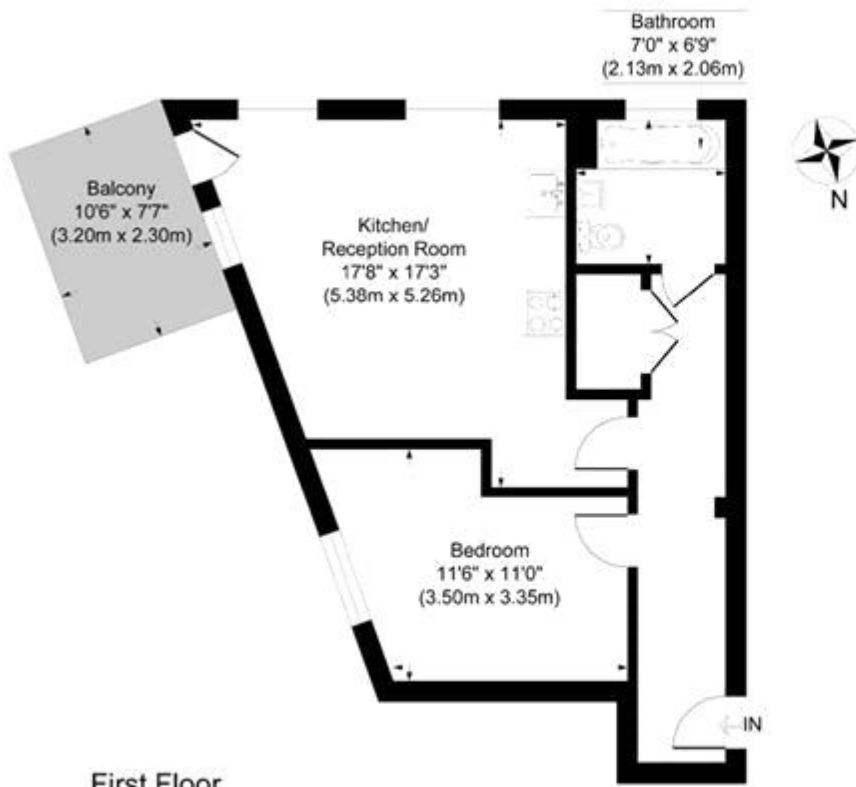

Fairway Court Culvert Drive

Approximate Gross Internal Area
Total = 51.3 sq m / 553 sq ft

This plan is for layout guidance only. Not drawn to scale unless stated. Windows and door openings are approximate. Whilst every care is taken in the preparation of this plan, please check all dimensions, shapes and compass bearings before making any decisions reliant upon them.

generated by
THE360IMAGE
www.the360image.co.uk

Energy Efficiency Rating		Current	Potential
<i>Very energy efficient - lower running costs</i>			
(92-)	A		
(81-91)	B	85	85
(69-80)	C		
(55-68)	D		
(39-54)	E		
(21-38)	F		
(1-20)	G		
<i>Not energy efficient - higher running costs</i>			
England & Wales		EU Directive 2002/91/EC	

The energy efficiency rating is a measure of the overall efficiency of a home. The higher the rating the more energy efficient the home is and the lower the fuel bills will be.



Whilst every effort is made to ensure the accuracy of these details, it should be noted that the measurements are approximate only. Floorplans are for representation purposes only and prepared according to the RICS Code of Measuring Practice by our floorplan provider. Therefore, the layout of doors, windows and rooms are approximate and should be regarded as such by any prospective tenant.